

# SETUPGUIDE

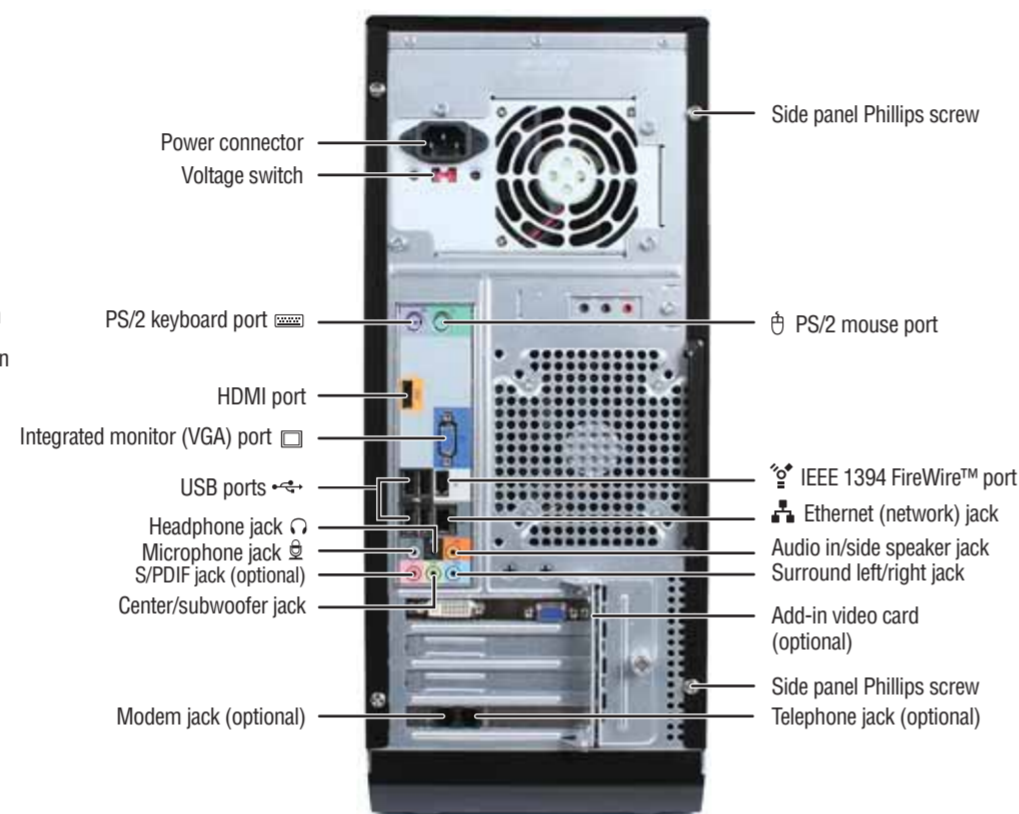

## FRONT (may vary with options)

## BACK (may vary with options)



Your Gateway computer is packed with many powerful features. Icons and color coding help make setting up your computer as easy as possible.

### 1 Connect the mouse and keyboard

If you have a wireless mouse or keyboard, follow the instructions that came with them.



### 2 Connect the monitor (depending on your model)

If available, connect to Add-in video (HDMI, DVI, or VGA), otherwise connect to integrated video (HDMI or VGA). The integrated video port is disabled if you have add-in video.

Note: You can use the included DVI-to-VGA adapter to connect a VGA monitor to a DVI video port.

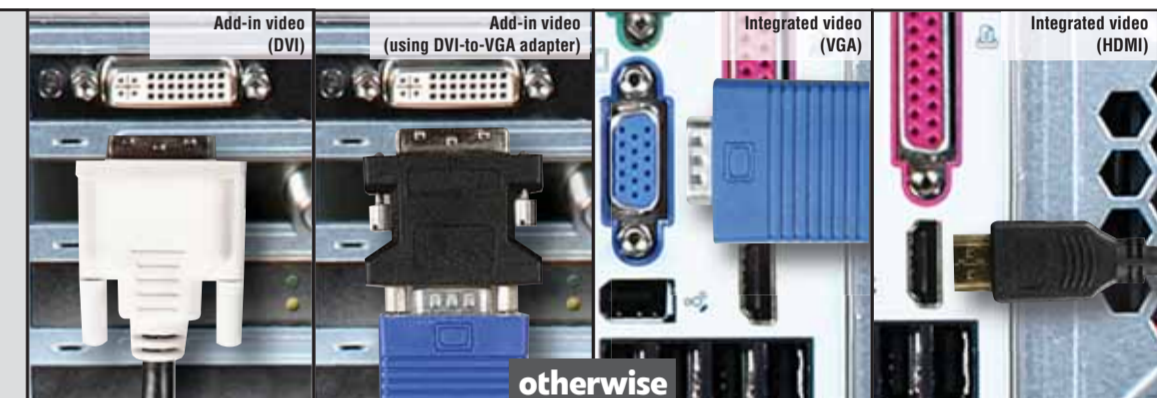

### 3 Connect the speakers (optional)

Follow the instructions that came with your speakers.

Note: If you ordered an audio card with your computer, connect your speakers to the card's jacks. Integrated audio jacks are disabled when an audio card is installed.

Note: If you have a speaker bar, follow the instructions that came with it.



### 4 Connect the modem (optional)

Connect the telephone modem cable to the modem jack and telephone wall jack. You can connect your telephone to the telephone jack.



### 5 Connect the network (optional)

Connect the network (RJ45) cable to the Ethernet jack and a cable modem, DSL modem, or network jack.

NOTE: For detailed network and Internet setup instructions, see your online *User Guide*.



### 6 Connect the power cord

Connect the power cable to the computer, then plug it into a power source. To protect your system from power fluctuations, use a surge protector.

WARNING: To protect your computer during electrical storms, unplug the power cord, modem, and network cables.



### 7 Turn on the power (⏻)

Turn on the monitor and computer. Follow the Windows setup screen instructions.

IMPORTANT: Connect devices, such as a printer or scanner, after you complete the Windows setup. Follow the instructions that came with the device.

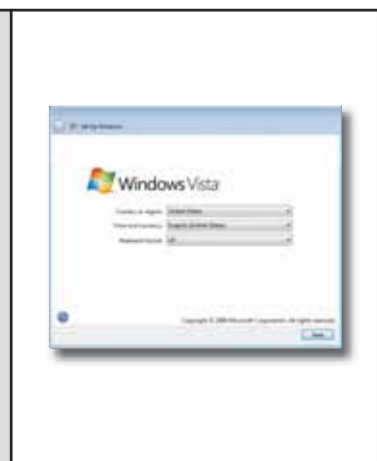

## FOR EXTRA HELP...

**SEE YOUR DOCUMENTATION.** For detailed information about using your Gateway computer, see the *User Guide* or *Reference Guide* provided. To access the online guides, click **Ⓜ** (Start), **All Programs**, then click **Gateway Documentation**.

**CHECK GATEWAY SUPPORT.** For help and information about common issues, or for additional help setting up your computer, visit the Gateway Support Web site at [support.gateway.com](http://support.gateway.com).

**CONTACT TECH SUPPORT.** To speak with a technical support representative, call toll-free 866-539-3901 (U.S.) or 800-297-5980 (Canada).

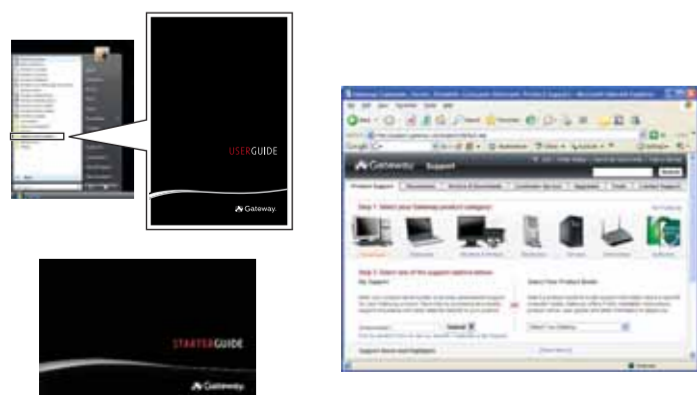

**SEE YOUR STARTER GUIDE.** After setting up your computer, read the *Starter Guide* for tips on using your computer.

## SERIAL NUMBER AND CONTACT INFORMATION LABEL

Gateway Customer Care telephone numbers vary by country or region.

